

ADAPTOR FEMALE ORFS - FEMALE ORFS

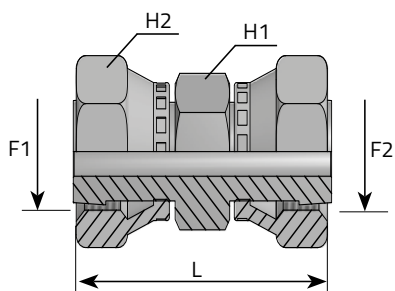

ADATTATORE DIRITTO FEMMINA ORFS - FEMMINA ORFS DADO PRESSATO
 ADAPTATEUR FEMELLE ORFS - FEMELLE ORFS
 ADAPTER IG-ORFS/IG-ORFS
 ADAPTADOR HEMBRA ORFS - HEMBRA ORFS

F1 ORFS

F2 ORFS

| Code | Thread | | Dimensions | | | Pressure | |
|--------|---------|---------|------------|----|------|----------|------|
| | F1 | F2 | H1 | H2 | L | Bar | Psi |
| | | | mm | mm | mm | | |
| AFGO06 | 9/16 | 9/16 | 17 | 17 | 39.5 | 630 | 9136 |
| AFGO09 | 11/16 | 11/16 | 19 | 22 | 45 | 630 | 9136 |
| AFGO11 | 13/16 | 13/16 | 22 | 24 | 51.5 | 630 | 9136 |
| AFGO13 | 1 | 1 | 27 | 30 | 61.5 | 420 | 6091 |
| AFGO14 | 1.3/16 | 1.3/16 | 32 | 36 | 68 | 420 | 6091 |
| AFGO15 | 1.7/16 | 1.7/16 | 41 | 41 | 71.5 | 420 | 6091 |
| AFGO21 | 1.11/16 | 1.11/16 | 46 | 50 | 73.5 | 280 | 4060 |
| AFGO32 | 2 | 2 | 55 | 60 | 75 | 280 | 4060 |