

Adattatore diritto Femmina girevole JIC Maschio Gas cilindrico forma E DIN 3852 (1)

Adaptor swivel female JIC - male BSPP form E
Adaptateur femelle tournante JIC - mâle BSPP
forme E
Adapter IG-JIC drehbar / AGR-F form E
Adaptador hembra giratoria JIC - macho BSPP
forma E

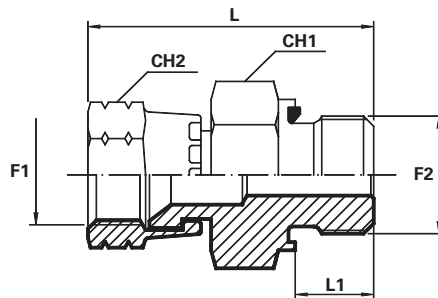

F1 - JIC
F2 - BSPP, Gas cylindrique, Zylinder - Gasgewindr,
Gas cilindrca

* **Dado spinato**
Thrust-wire nut

Codice Code Référence Bestell Nr. Código	Filetto Thread Filet Gewinde Rosca		Dimensioni Dimensions Dimensions Masszahlen Dimensiones				PN Bar
	F1	F2	CH1 mm	CH2 mm	L1 mm	L mm	
AFGJ04MG02R	7/16"	1/8"	14	14	8	34	310
AFGJ04MG04R	7/16"	1/4"	19	14	12	37.5	275
AFGJ04MG06R	7/16"	3/8"	22	14	12	39.5	275
AFGJ05MG02R	1/2"	1/8"	14	17	8	35.5	275
AFGJ05MG04R	1/2"	1/4"	19	17	12	39	275
AFGJ05MG06R	1/2"	3/8"	22	17	12	41	210
AFGJ06MG04R	9/16"	1/4"	19	19	12	39.8	275
AFGJ06MG06R	9/16"	3/8"	22	19	12	41.8	210
AFGJ06MG08R	9/16"	1/2"	27	19	14	45.3	210
AFGJ08MG04R	3/4"	1/4"	22	19	12	42.1	275
AFGJ08MG06R	3/4"	3/8"	22	22	12	44.1	275
AFGJ08MG08R	3/4"	1/2"	27	22	14	47.6	210
AFGJ10MG06R	7/8"	3/8"	22	27	12	48.1	210
AFGJ10MG08R	7/8"	1/2"	27	27	14	51.6	210
AFGJ10MG12R	7/8"	3/4"	32	27	16	55.1	210
AFGJ12MG08R*	1".1/16	1/2"	27	32	14	51.7	210
AFGJ12MG12R*	1".1/16	3/4"	32	32	16	55.2	210
AFGJ12MG16R*	1".1/16	1"	41	32	18	58.7	170
AFGJ16MG12R*	1".5/16	3/4"	32	41	16	58.9	170

Adattatore diritto Femmina girevole JIC Maschio Gas cilindrico **forma E** DIN 3852 (2)

Adaptor swivel female JIC - male BSPP form E
Adaptateur femelle tournante JIC - mâle BSPP
forme E
Adapter IG-JIC drehbar / AGR-F form E
Adaptador hembra giratoria JIC - macho BSPP
forma E

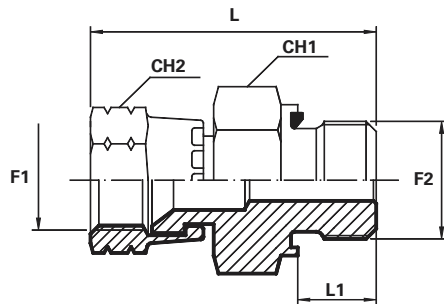

F1 - JIC
F2 BSPP, Gas cylindrique, Zylinder - Gasgewindr,
Gas cilindrca

* **Dado spinato**
Thrust-wire nut

Codice Code Référence Bestell Nr. Código	Filetto Thread Filet Gewinde Rosca		Dimensioni Dimensions Dimensions Masszahlen Dimensiones				PN Bar
	F1	F2	CH1 mm	CH2 mm	L1 mm	L mm	
AFGJ16MG16R*	1".5/16	1"	41	41	18	62	170
AFGJ16MG20R*	1".5/16	1".1/4	50	41	20	66.9	170
AFGJ20MG16R*	1".5/8	1"	41	50	18	62.8	140
AFGJ20MG20R*	1".5/8	1".1/4	50	50	20	67.3	140
AFGJ24MG20R*	1".7/8	1".1/4	50	60	20	74.3	105