

ADAPTOR FEMALE ORFS - MALE METRIC FORM E

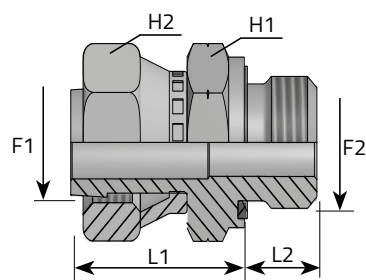

ADATTATORE DIRITTO FEMMINA ORFS MASCHIO METRICO FORMA E
 ADAPTEUR FEMELLE ORFS - MÂLE MÉTRIQUE FORME E
 ADAPTER IG-ORFS/AG-METRISCH FORM E
 ADAPTADOR HEMBRA ORFS - MACHO MÉTRICO FORMA E

F1 ORFS

F2 Metrisch, Metrico, Metric, Métrique, Métrico

| Code | Thread | | Dimensions | | | | Pressure | |
|-------------|---------|--------|------------|----|------|----|----------|------|
| | F1 | F2 | H1 | H2 | L1 | L2 | Bar | Psi |
| | | | mm | mm | mm | mm | | |
| AFGO06MM12R | 9/16 | 12X1.5 | 17 | 17 | 26.5 | 12 | 630 | 9136 |
| AFGO09MM14R | 11/16 | 14X1.5 | 19 | 22 | 28.5 | 12 | 630 | 9136 |
| AFGO11MM18R | 13/16 | 18X1.5 | 24 | 24 | 35.5 | 12 | 630 | 9136 |
| AFGO13MM22R | 1 | 22X1.5 | 27 | 30 | 38 | 14 | 420 | 6091 |
| AFGO14MM27R | 1.3/16 | 27X2 | 32 | 36 | 41.5 | 16 | 420 | 6091 |
| AFGO15MM33R | 1.7/16 | 33X2 | 41 | 41 | 49 | 18 | 420 | 6091 |
| AFGO21MM42R | 1.11/16 | 42X2 | 50 | 50 | 49 | 20 | 280 | 4060 |
| AFGO32MM48R | 2 | 48X2 | 55 | 60 | 49 | 22 | 280 | 4060 |
| AFGO06MM10R | 9/16 | 10X1 | 17 | 17 | 26.5 | 8 | 350 | 5076 |
| AFGO09MM16R | 11/16 | 16X1.5 | 22 | 22 | 28.5 | 12 | 630 | 9136 |
| AFGO11MM16R | 13/16 | 16X1.5 | 22 | 24 | 31.5 | 12 | 630 | 9136 |
| AFGO13MM18R | 1 | 18X1.5 | 27 | 30 | 38 | 12 | 420 | 6091 |
| AFGO14MM22R | 1.3/16 | 22X1.5 | 32 | 36 | 41.5 | 14 | 420 | 6091 |
| AFGO15MM27R | 1.7/16 | 27X2 | 41 | 41 | 49 | 16 | 420 | 6091 |